



**To:** Prospective Bidders  
**From:** Wold Architects and Engineers  
**Date:** April 6, 2024  
**Comm. No:** 227052  
**SBC No:** 166/011-01-2022CM



---

**Subject:** Addendum No. 1  
New Tucker Stadium West  
Package 1 - Demolition

This addendum forms a part of the Contract Documents dated March 7, 2024. Acknowledge receipt of this Addendum on the space provided on the Bid Form. Failure to do so may result in disqualification of Bid.

This Addendum consists of two pages (2) typed sheets and attachments:

Drawings:

CD 0.03 – DEMOLITION PLAN  
CD 1.10 – INITIAL PHASE EROSION CONTROL  
CD 1.11 – FINAL STABILIZATION PLAN  
CD 2.11 – UTILITY PLAN

#### DRAWINGS

- DRAWING CD 0.03 – DEMOLITION PLAN: Replace the original sheet with the attached:
  - Extend the limits of track demolition on the north end.
  - Revise note for scope clarification of fiber work.
  - Revise location of construction fence on north end for track removal.
  - Add fiber line demolition at the south end of the existing stadium.
- DRAWING CD 1.10 – INITIAL PHASE EROSION CONTROL: Replace the original sheet with the attached.
  - Add erosion control features around extended track removal.
- DRAWING CD 1.11 – FINAL STABILIZATION PLAN: Replace the original sheet with the attached:
  - Add erosion control features around extended track removal.
  - Revise limits of gravel coverage to the 1114.5 elevation.



4. DRAWING CD 2.11 – UTILITY PLAN: Replace the original sheet with the attached.
  - A. Add quazite pullbox for scoreboard cabling as shown.
  - B. Revise note for scope clarification of fiber work.
  - C. Revise final elevation of proposed pad to 1114.50.

**END OF ADDENDUM #1**

PROJECT LOCATION: NEW WEST TUCKER STADIUM (WORLD 270203) PROJECT FILES: C:\DEMOLITION\ANSI\CD03\BASE 270203.DWG  
DATE: 07/28/24 11:41:53 AM (HANDS) LOCATION: C:\USERS\ARCHDESIGN\WORLD\ARCHT\3836\16041-01-2022 - NEW WEST TUCKER STADIUM (WORLD 270203) PROJECT FILES: C:\DEMOLITION\ANSI\CD03\BASE 270203.DWG  
© COPYRIGHT 2024 - ALL RIGHTS RESERVED. NO PORTIONS OF THIS DOCUMENT MAY BE REPRODUCED WITHOUT THE EXPRESSED WRITTEN CONSENT OF WOLD ARCHITECTS AND ENGINEERS.

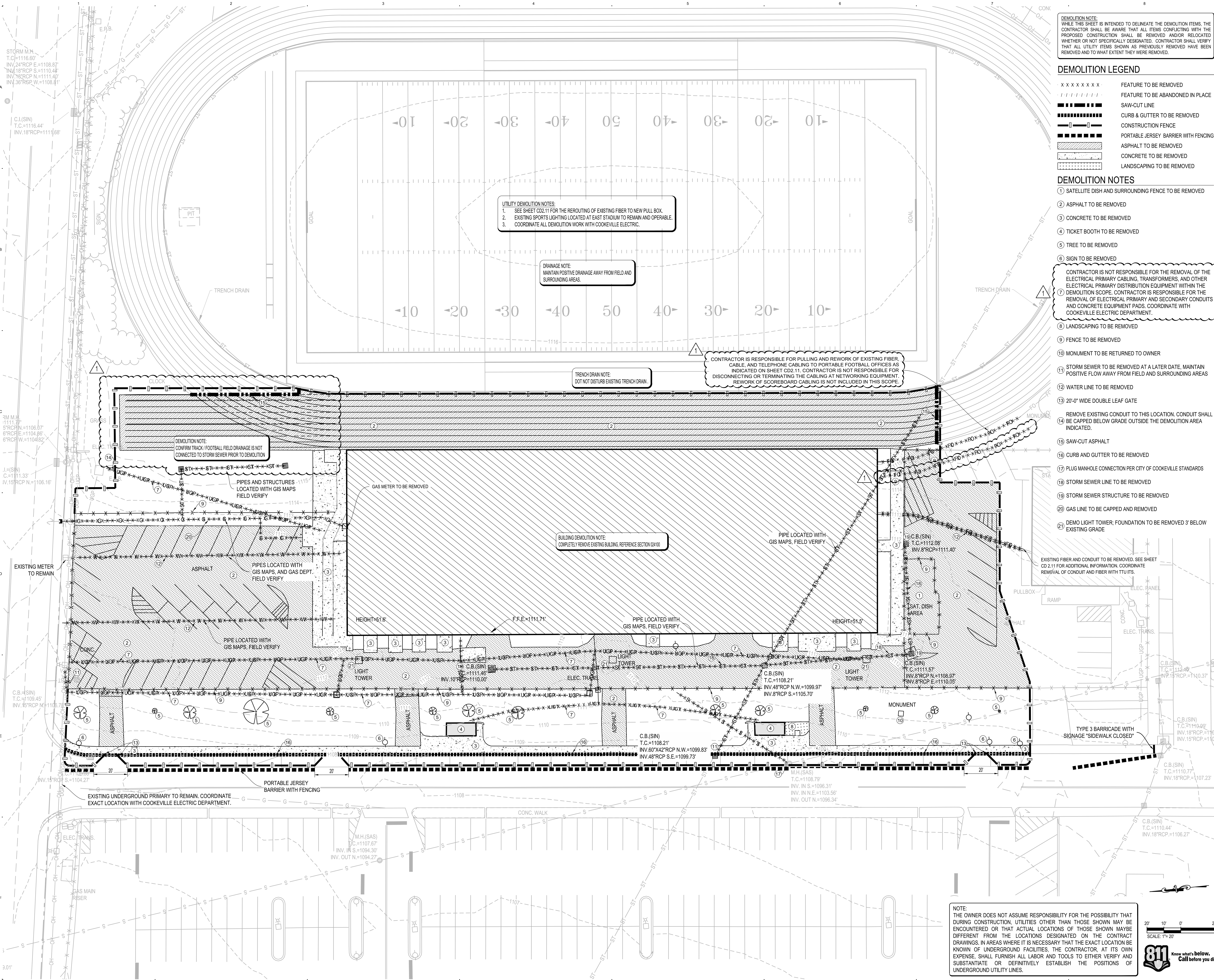

**DEMOLITION NOTE:**  
WHILE THIS SHEET IS INTENDED TO DELINEATE THE DEMOLITION ITEMS, THE CONTRACTOR SHALL BE AWARE THAT ALL ITEMS CONFLICTING WITH THE PROPOSED CONSTRUCTION SHALL BE REMOVED AND/OR RELOCATED WHETHER OR NOT SPECIFICALLY DESIGNATED. CONTRACTOR SHALL VERIFY THAT ALL UTILITY ITEMS SHOWN AS PREVIOUSLY REMOVED HAVE BEEN REMOVED AND TO WHAT EXTENT THEY WERE REMOVED.

- DEMOLITION LEGEND**
- XXXXXX FEATURE TO BE REMOVED
  - - - - - FEATURE TO BE ABANDONED IN PLACE
  - ||||| SAW-CUT LINE
  - ===== CURB & GUTTER TO BE REMOVED
  - |--- CONSTRUCTION FENCE
  - ||||| PORTABLE JERSEY BARRIER WITH FENCING
  - ||||| ASPHALT TO BE REMOVED
  - ||||| CONCRETE TO BE REMOVED
  - ||||| LANDSCAPING TO BE REMOVED

- DEMOLITION NOTES**
- 1 SATellite DISH AND SURROUNDING FENCE TO BE REMOVED
  - 2 ASPHALT TO BE REMOVED
  - 3 CONCRETE TO BE REMOVED
  - 4 TICKET BOOTH TO BE REMOVED
  - 5 TREE TO BE REMOVED
  - 6 SIGN TO BE REMOVED
  - 7 CONTRACTOR IS NOT RESPONSIBLE FOR THE REMOVAL OF THE ELECTRICAL PRIMARY CABLING, TRANSFORMERS, AND OTHER ELECTRICAL PRIMARY DISTRIBUTION EQUIPMENT WITHIN THE DEMOLITION SCOPE. CONTRACTOR IS RESPONSIBLE FOR THE REMOVAL OF ELECTRICAL PRIMARY AND SECONDARY CONDUITS AND CONCRETE EQUIPMENT PADS. COORDINATE WITH COOKEVILLE ELECTRIC DEPARTMENT.
  - 8 LANDSCAPING TO BE REMOVED
  - 9 FENCE TO BE REMOVED
  - 10 MONUMENT TO BE RETURNED TO OWNER
  - 11 STORM SEWER TO BE REMOVED AT A LATER DATE, MAINTAIN POSITIVE FLOW AWAY FROM FIELD AND SURROUNDING AREAS
  - 12 WATER LINE TO BE REMOVED
  - 13 20'-0" WIDE DOUBLE LEAF GATE
  - 14 REMOVE EXISTING CONDUIT TO THIS LOCATION. CONDUIT SHALL BE CAPPED BELOW GRADE OUTSIDE THE DEMOLITION AREA INDICATED.
  - 15 SAW-CUT ASPHALT
  - 16 CURB AND GUTTER TO BE REMOVED
  - 17 PLUG MANHOLE CONNECTION PER CITY OF COOKEVILLE STANDARDS
  - 18 STORM SEWER LINE TO BE REMOVED
  - 19 STORM SEWER STRUCTURE TO BE REMOVED
  - 20 GAS LINE TO BE CAPPED AND REMOVED
  - 21 DEMO LIGHT TOWER, FOUNDATION TO BE REMOVED 3' BELOW EXISTING GRADE

**UTILITY DEMOLITION NOTES:**  
 1. SEE SHEET CD2.11 FOR THE REROUTING OF EXISTING FIBER TO NEW PULL BOX.  
 2. EXISTING SPORTS LIGHTING LOCATED AT EAST STADIUM TO REMAIN AND OPERABLE.  
 3. COORDINATE ALL DEMOLITION WORK WITH COOKEVILLE ELECTRIC.

**DRAINAGE NOTE:**  
 MAINTAIN POSITIVE DRAINAGE AWAY FROM FIELD AND SURROUNDING AREAS.

**TRENCH DRAIN NOTE:**  
 DOT NOT DISTURB EXISTING TRENCH DRAIN.

CONTRACTOR IS RESPONSIBLE FOR PULLING AND REWORK OF EXISTING FIBER CABLE, AND TELEPHONE CABLING TO PORTABLE FOOTBALL OFFICES AS INDICATED ON SHEET CD2.11. CONTRACTOR IS NOT RESPONSIBLE FOR DISCONNECTING OR TERMINATING THE CABLING AT NETWORKING EQUIPMENT. REWORK OF SCOREBOARD CABLING IS NOT INCLUDED IN THIS SCOPE.

**BUILDING DEMOLITION NOTE:**  
 COMPLETELY REMOVE EXISTING BUILDING. REFERENCE SECTION 02410

EXISTING FIBER AND CONDUIT TO BE REMOVED. SEE SHEET CD 2.11 FOR ADDITIONAL INFORMATION. COORDINATE REMOVAL OF CONDUIT AND FIBER WITH TTI ITS.

**NOTE:**  
 THE OWNER DOES NOT ASSUME RESPONSIBILITY FOR THE POSSIBILITY THAT DURING CONSTRUCTION, UTILITIES OTHER THAN THOSE SHOWN MAY BE ENCOUNTERED OR THAT ACTUAL LOCATIONS OF THOSE SHOWN MAYBE DIFFERENT FROM THE LOCATIONS DESIGNATED ON THE CONTRACT DRAWINGS. IN AREAS WHERE IT IS NECESSARY THAT THE EXACT LOCATION BE KNOWN OF UNDERGROUND FACILITIES, THE CONTRACTOR, AT ITS OWN EXPENSE, SHALL FURNISH ALL LABOR AND TOOLS TO EITHER VERIFY AND SUBSTANTIATE OR DEFINITELY ESTABLISH THE POSITIONS OF UNDERGROUND UTILITY LINES.



**NEW TUCKER STADIUM WEST PACKAGE 1 - DEMOLITION**

SBC# 166/011-01-2022CM

1151 Stadium Drive  
 Cookeville, TN 38501

**TENNESSEE TECHNOLOGICAL UNIVERSITY**



**WOLD ARCHITECTS AND ENGINEERS**  
 214 Centerview Drive Suite 300  
 Brentwood, TN 37027

wolddae.com | 615.370.8500

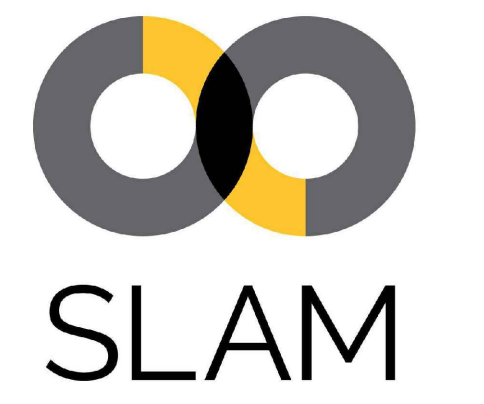

**THE S/L/A/M COLLABORATIVE**  
 675 Ponce De Leon Ave NE, Ste 4100  
 Atlanta, GA 38301

slamcoll.com | 404.853.5115

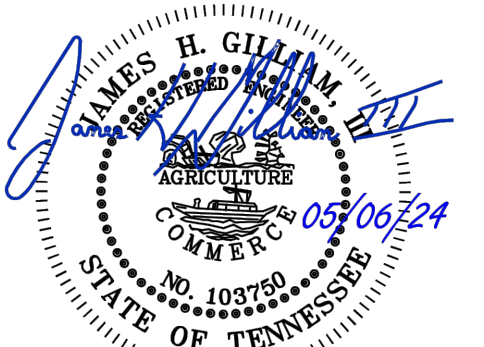

Revisions	
Description	Date
Addendum #1	05.08.2024

Proj. # 227052  
 Date: 03.06.2024  
 Drawn: ALR  
 Check: JG

**DEMOLITION PLAN**

**CD 0.03**

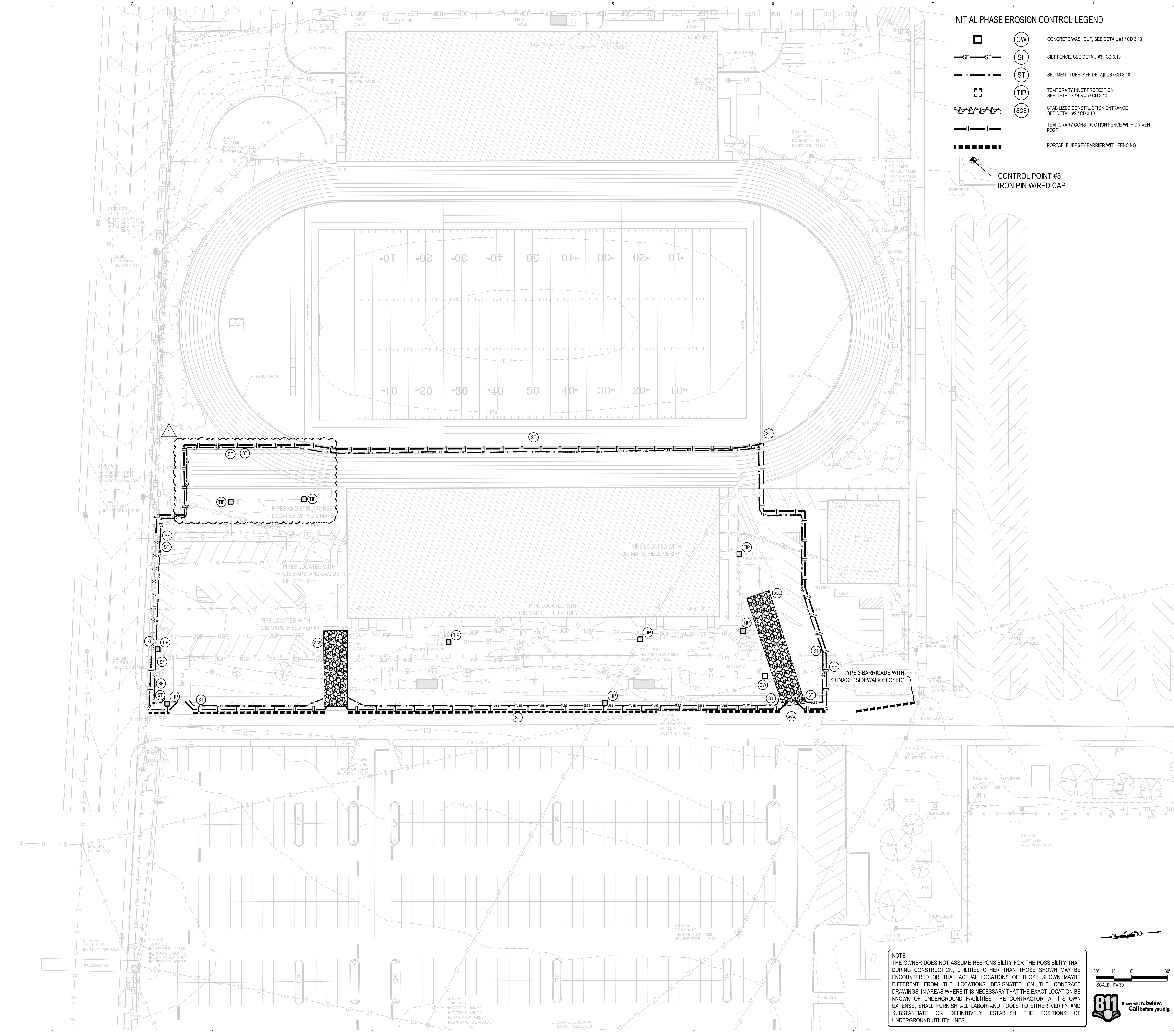

INITIAL PHASE EROSION CONTROL LEGEND

- CONCRETE WASHOUT, SEE DETAIL #1 / CD 3.10
- SILT FENCE, SEE DETAIL #3 / CD 3.10
- SEDIMENT TUBE, SEE DETAIL #6 / CD 3.10
- TEMPORARY INLET PROTECTION, SEE DETAILS #4 & #5 / CD 3.10
- STABILIZED CONSTRUCTION ENTRANCE, SEE DETAIL #2 / CD 3.10
- TEMPORARY CONSTRUCTION FENCE WITH DRIVE POST
- PORTABLE JERSEY BARRIER WITH FENCING

CONTROL POINT #3  
IRON PIN W/RED CAP



NEW TUCKER STADIUM WEST  
PACKAGE 1 - DEMOLITION

SBC# 166/011-01-2022CM

1151 Stadium Drive  
Cookeville, TN 38501

TENNESSEE  
TECHNOLOGICAL  
UNIVERSITY



WOLD ARCHITECTS  
AND ENGINEERS

214 Centerview Drive Suite 300  
Brentwood, TN 37027

woldae.com | 615.370.8500



THE S/L/A/M  
COLLABORATIVE

675 Ponce de Leon Ave NE, Ste 4100  
Atlanta, GA 38301

slamcoll.com | 404.853.5115

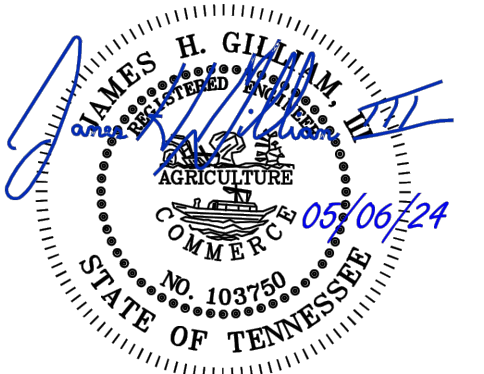

Description	Revisions	
	Date	Num
Addendum #1	05.08.2024	1

Proj. # 227052  
Date: 03.06.2024  
Drawn: ALR  
Check: JG

INITIAL PHASE  
EROSION CONTROL  
PLAN

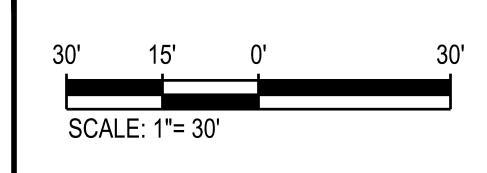

CD 1.10

PLOT DATE: 07/28/24 (14:25 AM HARVARD) LOCATION: C:\USERS\AJG\DRAWINGS\CD\CD\30X42\NEW WEST TUCKER STADIUM\WOL\27022\PROJECT FILES\CD\FINAL DEMOLITION PLAN-SUB AREA 1.DWG  
 © COPYRIGHT 2024 - ALL RIGHTS RESERVED. NO PORTIONS OF THIS DOCUMENT MAY BE REPRODUCED WITHOUT THE EXPRESS WRITTEN CONSENT OF WOLD ARCHITECTS AND ENGINEERS

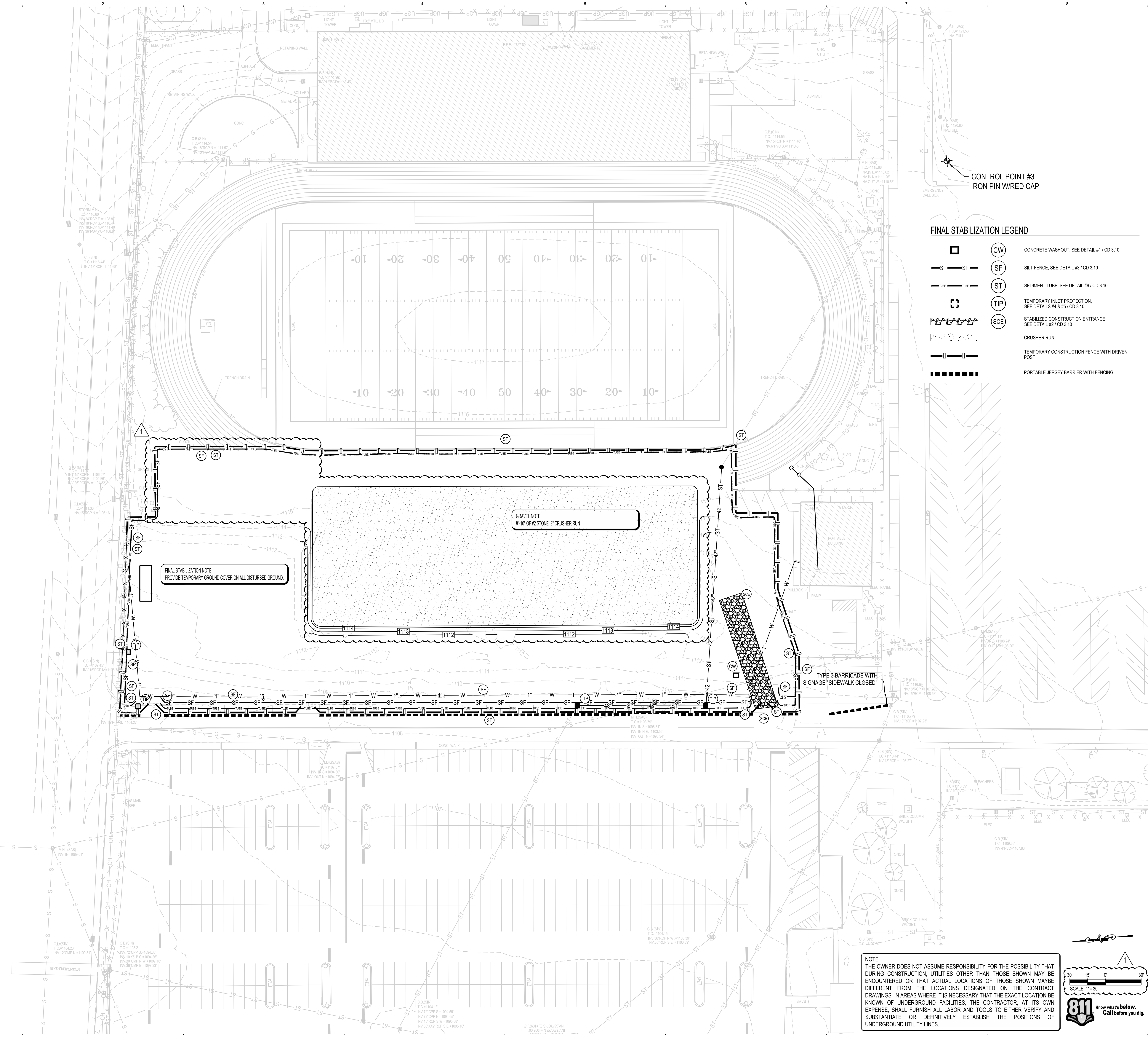

CONTROL POINT #3  
IRON PIN W/RED CAP

**FINAL STABILIZATION LEGEND**

- (CW) CONCRETE WASHOUT, SEE DETAIL #1 / CD 3.10
- (SF) SILT FENCE, SEE DETAIL #3 / CD 3.10
- (ST) SEDIMENT TUBE, SEE DETAIL #6 / CD 3.10
- (TIP) TEMPORARY INLET PROTECTION, SEE DETAILS #4 & #5 / CD 3.10
- (SCE) STABILIZED CONSTRUCTION ENTRANCE, SEE DETAIL #2 / CD 3.10
- CRUSHER RUN
- TEMPORARY CONSTRUCTION FENCE WITH DRIVEN POST
- PORTABLE JERSEY BARRIER WITH FENCING

**FINAL STABILIZATION NOTE:**  
PROVIDE TEMPORARY GROUND COVER ON ALL DISTURBED GROUND.

**GRAVEL NOTE:**  
8" 10' OF #2 STONE, 2' CRUSHER RUN

TYPE 3 BARRICADE WITH  
SIGNAGE 'SIDEWALK CLOSED'

**NOTE:**  
THE OWNER DOES NOT ASSUME RESPONSIBILITY FOR THE POSSIBILITY THAT DURING CONSTRUCTION, UTILITIES OTHER THAN THOSE SHOWN MAY BE ENCOUNTERED OR THAT ACTUAL LOCATIONS OF THOSE SHOWN MAYBE DIFFERENT FROM THE LOCATIONS DESIGNATED ON THE CONTRACT DRAWINGS. IN AREAS WHERE IT IS NECESSARY THAT THE EXACT LOCATION BE KNOWN OF UNDERGROUND FACILITIES, THE CONTRACTOR, AT ITS OWN EXPENSE, SHALL FURNISH ALL LABOR AND TOOLS TO EITHER VERIFY AND SUBSTANTIATE OR DEFINITELY ESTABLISH THE POSITIONS OF UNDERGROUND UTILITY LINES.

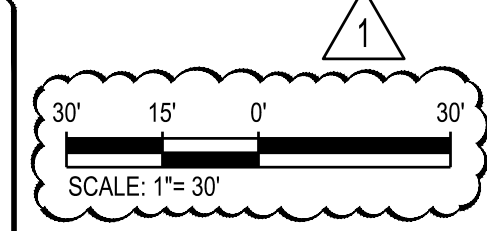

**NEW TUCKER STADIUM WEST PACKAGE 1 - DEMOLITION**

SBC# 166/011-01-2022CM

1151 Stadium Drive  
Cookeville, TN 38501

**TENNESSEE TECHNOLOGICAL UNIVERSITY**



**WOLD ARCHITECTS AND ENGINEERS**  
214 Centerville Drive Suite 300  
Brentwood, TN 37027

woldae.com | 615.370.8500

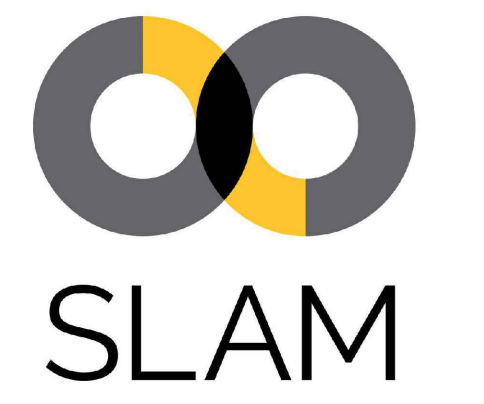

**THE S/L/A/M COLLABORATIVE**  
675 Ponce De Leon Ave NE, Ste 4100  
Atlanta, GA 38301

slamcoll.com | 404.853.5115

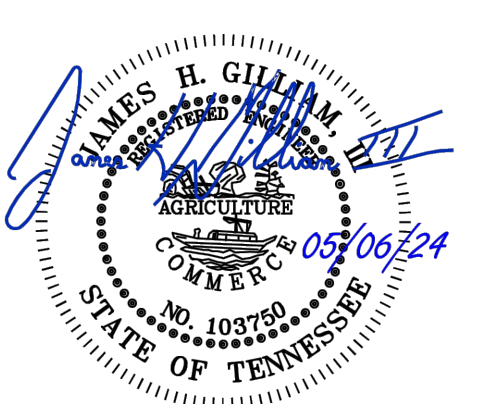

Description	Revisions	
	Date	Num
Addendum #1	05.08.2024	1

Proj. # 227052  
Date: 03.08.2024  
Drawn: ALR  
Check: JG

**FINAL STABILIZATION PLAN**

30X42

TN

PROJECT DATE: 03/06/2024 11:40:35 AM (HOURS) LOCATION: C:\USERS\ADMIN\DWG\CD211\CD211.DWG PROJECT FILE: C:\USERS\ADMIN\DWG\CD211\CD211.DWG  
© COPYRIGHT 2024 - ALL RIGHTS RESERVED. NO PORTIONS OF THIS DOCUMENT MAY BE REPRODUCED WITHOUT THE EXPRESSED WRITTEN CONSENT OF WOLD ARCHITECTS AND ENGINEERS

C

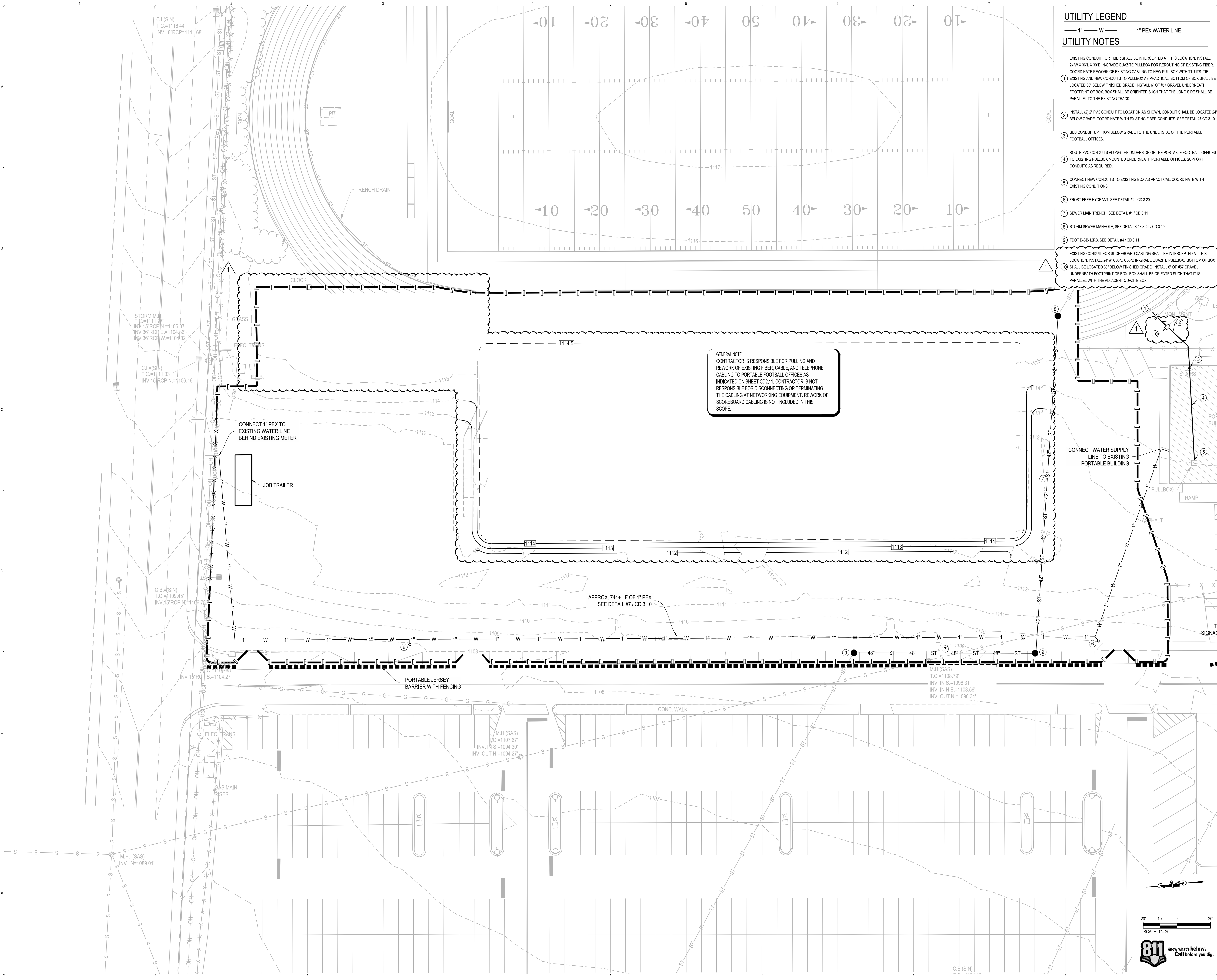

**NEW TUCKER STADIUM WEST PACKAGE 1 - DEMOLITION**

**SBC# 166/011-01-2022CM**

1151 Stadium Drive  
 Cookeville, TN 38501

**TENNESSEE TECHNOLOGICAL UNIVERSITY**



**WOLD ARCHITECTS AND ENGINEERS**

214 CenterView Drive Suite 300  
 Brentwood, TN 37027



**THE S/L/A/M COLLABORATIVE**

675 Ponce De Leon Ave NE, Ste 4100  
 Atlanta, GA 38301



Description	Revisions	
	Date	Num
Addendum #1	05.08.2024	1

Proj. # 227052  
 Date: 03.06.2024  
 Drawn: ALR  
 Check: JG

**UTILITY PLAN**

**CD 2.11**