

ADDENDUM NO. 1
CAMPUS WIDE EXTERIOR LIGHTING UPGRADES
TENNESSEE TECHNOLOGICAL UNIVERSITY
SBC No. 364/011-08-2021
September 10, 2025

The original construction documents dated August 18, 2025, are hereby amended as described hereinafter. All bidders shall acknowledge receipt of Addendum No. 1 in the Bid Form.



1. Refer to Drawings: Replace Drawings E0.1, E2.2, E3.1, E6.1, and E7.1 currently in the bid documents with attached Revision # 1 Drawings E0.1, E2.2, E3.1, E6.1, and E7.1 dated 9-10-25.

END OF ADDENDUM NO. 1



LIGHTING FIXTURE SCHEDULE													
DESIGNATION	ILLUMINATION				MOUNTING			DESCRIPTION: SHIELDING, TYPE MATERIALS, FINISH, MOUNTING	MANUFACTURER'S PRODUCT ITEM		* EQUAL PRODUCT PERMITTED		APPROVED EQUAL MANUFACTURES
	WATTS	DELIVERED LUMENS	COLOR TEMPERATURE (°K)	MINIMUM CRI	CEILING		WALL						
					PENDANT STEM LENGTH	SURFACE RECESSED			HEIGHT ABOVE FINISHED FLOOR OR GRADE	COMPANY	CATALOG NO.	YES	
A1	140	18,000	4000	80	•			WALL MOUNTED FULL CUTOFF TRAPEZOIDAL FIXTURE, LARGE PROFILE, BLACK FINISH, FORWARD THROW OPTICS	LITHONIA	WDGE4-LED- P4-40K- 80CRI-R4- MVOLT-SRM- DBLXO	•		MCGRAW EDISON GARDCO
A2	15	2000	4000	80	•			WALL MOUNTED FULL CUTOFF TRAPEZOIDAL FIXTURE, MEDIUM PROFILE, BLACK FINISH, FORWARD THROW OPTICS, BUILT-IN BATTERY PACK	LITHONIA	WDGE2-LED- P2-40K- 80CRI-VF- MVOLT-E4WH- DBLXO	•		MCGRAW EDISON GARDCO
A3	10	1200	4000	80	•			WALL MOUNTED FULL CUTOFF TRAPEZOIDAL FIXTURE, SMALL PROFILE, BLACK FINISH, FORWARD THROW OPTICS, BUILT-IN BATTERY PACK	LITHONIA	WDGE1-LED- P1-40K- 80CRI-VF- MVOLT-E4WH- DBLXO	•		MCGRAW EDISON GARDCO
A4	13	1500	4000	80				EXISTING WALL SCENCE TO REMAIN, CLEAN AND RELAMP WITH LED "A" LAMP	-	-			
A5	20	1500	4000	80	•			WALL MOUNTED EXTERIOR CYLINDER, DOWNLIGHT COMPONENT ONLY, BLACK FINISH, TYPE 2 DISTRIBUTION	LIGMAN	UTA-31861- 2ZW-12-W40- 01-120/277V-			H.E. WILLIAMS PORTFOLIO KIRLIN
B	15.6	2000	4000	80	•			2x2 LOW PROFILE SURFACE UNDERCANYOPY LIGHT, DAMP LOCATION LISTED, SURFACE MOUNTING KIT	LITHONIA	CPX 2X2- 200LM- 80CRI-40K- SWL-MIN10- MVOLT-2X2 SMKSH	•		COLUMBIA H.E. WILLIAMS
C	-	-	4000	80	•			DECORATIVE LANTERN, SEE DECORATIVE LANTERN SCHEDULE ON THIS DRAWING FOR ADDITIONAL INFORMATION					
D	15.7	1500	4000	80	•			UNDER EAVE MOUNTED CYLINDER, 4" DIAMETER, 5 13/16" DEEP, WET LOCATION LISTED, WHITE FINISH AT DERRYBERKE, BLACK FINISH AT UNIVERSITY SERVICES	GOTHAM	IV04CYL-SC- D-15LM-40K- 80CRI-WD- MIN10-MVOLT- ZT-L5-JBX- WL-P-AR-LSS- DWH/DBL	•		KIRLIN PORTFOLIO OMEGA
E	13	1500	4000	80	•			COMPACT WALL UNIT ON METAL SIDING SYSTEM, DARK BRONZE FINISH, 5.5" WIDTH MAXIMUM, FIELD ADJUSTABLE COLOR TEMPERATURE	LITHONIA	WPXO-LED- AL04-SWW2- MVOLT-PE- DOBXO	•		MCGRAW EDISON GARDCO
F	20.3	2000	4000	80				UNDERCANYOPY LIGHT, 15" SQUARE, SURFACE MOUNT, BLACK FINISH, MARINE GRADE DIE CAST ALUMINUM HOUSING	KENALL	MS150-PP- MB-15L40K- DV	•		MCGRAW EDISON GARDCO
* UNLESS NOTED, EQUAL PRODUCT TO THAT SPECIFIED WILL BE ACCEPTED. THE DESIGN PROFESSIONAL SHALL HAVE SOLE JUDGEMENT CONCERNING EQUIVALENCY OF SUBSTITUTION.													

SITE POLE LIGHTING FIXTURE SCHEDULE													
DESIGNATION	ILLUMINATION				POLE DESCRIPTION: MATERIAL, SHAPE,			DESCRIPTION: SHIELDING, TYPE MATERIALS, FINISH, MOUNTING	MANUFACTURER'S PRODUCT ITEM			APPROVED EQUAL MANUFACTURES	
	WATTS	DELIVERED LUMENS	COLOR TEMPERATURE	ALUMINUM					STEEL	ROUND	SQUARE		HEIGHT ABOVE FINISHED GRADE
SA	165 (2)	20,000 (2)	4,000	•	•	25'-0"	POLE MOUNTED AREA LIGHT, TWO LUMINAIRES MOUNTED 180 DEGREES APART, FULL CUTOFF TYPE 4 FORWARD THROW OPTICS, BLACK FINISH, PROVIDE 5 PIN PHOTOCELL CONNECTOR AND PROGRAM TO BE CONTROLLED BY EXISTING TTU CAMPUS UBICQUA CONTROL SYSTEM			LITHONIA	RTA-5E-DM28AS-DBLXD-FBC	DSXLED-P6-40K-80CRI-T4M-MVOLT-RPA-DBLXD	MCGRAW EDISON GARDCO
SB	165	20,000	4,000	•	•	25'-0"	SAME AS TYPE "SA" FIXTURE, EXCEPT WITH JUST ONE LUMINAIRE			LITHONIA	RTA-5E-DM19AS-DBLXD-FBC	DSXLED-P6-40K-80CRI-T4M-MVOLT-RPA-DBLXD	MCGRAW EDISON GARDCO
SC	135	15,000	4,000	•	•	12'-0"	DECORATIVE POST TOP PEDESTRIAN LUMINAIRE WITH INTEGRAL TOP PIECE TO LIMIT "UPLIGHT", BLACK FINISH, PROVIDE 5 PIN PHOTOCELL CONNECTOR AND PROGRAM TO BE CONTROLLED BY EXISTING TTU CAMPUS UBICQUA CONTROL SYSTEM			GLOBAL GREEN (FIXTURE) HOLOPHANE (POLE)	HOLOPHANE A80BK	GLOBAL GREEN LPT-ACN-135-47-UDP-PT-FC2	HOLOPHANE GRANVILLE KING MARION SERIES PHILLIPS HADCO RL
SD	165 (2)	20,000 (2)	4,000	•	•	25'-0"	SAME AS TYPE "SA" FIXTURE, EXCEPT WITH TWO LUMINAIRES MOUNTED 90 DEGREES APART			LITHONIA	RTA-5E-DM29AS-DBLXD-FBC	DSXLED-P6-40K-80CRI-T4M-MVOLT-RPA-DBLXD	MCGRAW EDISON GARDCO
SE	165 (3)	20,000 (3)	4,000	•	•		SAME AS TYPE "SA" FIXTURE, EXCEPT WITH THREE LUMINAIRES MOUNTED 120 DEGREES APART			LITHONIA	RTA-5E-DM32AS-DBLXD-FBC	DSXLED-P6-40K-80CRI-T4M-MVOLT-RPA-DBLXD	MCGRAW EDISON GARDCO
SF	135	15,000	4,000	•	•	15'-0"	SAME AS TYPE "SC" FIXTURE, EXCEPT USE 15'-0" POLE INSTEAD OF 12'-0" POLE						

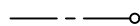
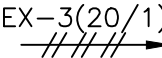
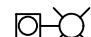
L E G E N D	
SYMBOL	DESCRIPTION
	DUPLEX PLUG RECEPTACLE, 120-VOLTS, 20-AMPERES, SHADED CENTER INDICATES EQUIPPED WITH BUILT-IN GROUND FAULT CIRCUIT INTERRUPTER, MOUNT 3" ABOVE BACKSPLASH AT WORK COUNTERS/LAVATORIES AND +18" AFF ELSEWHERE UNLESS NOTED TO A DIFFERENT HEIGHT. PROVIDE WEATHER RESISTANT DEVICE AND WATERPROOF "EXTRA DUTY WHILE IN USE" COVER WHERE LOCATED OUTDOORS. TAMPER RESISTANT, UNLESS NOT REQUIRED BY CODE.
	PANELBOARD, RECESSED OR SURFACE MOUNTED AS INDICATED ON DRAWINGS, TOP 6"-8" ABOVE FINISHED FLOOR ADJUSTED TO OCCUR AT A MASONRY JOINT. SEE PANELBOARD SCHEDULE FOR EQUIPMENT CONTAINED.
	CONDUIT IN THE FLOOR CONSTRUCTION OR UNDERGROUND SHOWN TURNING UP.
	HOMERUN CIRCUIT WIRING TO EXISTING PANELBOARD, NOTATION "3(20/1)" INDICATES HOMERUN WIRING TO BE CONNECTED TO THREE 20/1 CIRCUIT BREAKERS IN EXISTING PANELBOARD. CROSS LINES INDICATES THE NUMBER OF #12 AWG PHASE AND NEUTRAL CONDUCTORS WHERE MORE THAN TWO. SINGLE CIRCUIT BRANCH CIRCUIT WIRING RUNS SHOWN WITHOUT CROSS LINES SHALL BE PROVIDED WITH 2#12, 1#12G, EACH 20 AMPERE BRANCH CIRCUIT SHALL BE PROVIDED WITH SEPARATE NEUTRAL CONDUCTOR. SHARING OF NEUTRAL CONDUCTORS SHALL NOT BE PERMITTED. PROVIDE EQUIPMENT GROUNDING CONDUCTOR IN EACH CONDUIT RUN.
	POLE MOUNTED LIGHTING FIXTURE, SEE SITE LIGHTING FIXTURE AND SITE PLANS FOR ADDITIONAL INFORMATION.

BUILDING MOUNTED LIGHTING REPLACEMENT KEYED NOTES: ()

1. REMOVE EXISTING LIGHTING FIXTURE AND REPLACE WITH NEW LIGHTING FIXTURE. CONNECT NEW LIGHTING FIXTURE TO EXISTING WIRING SERVING LIGHTING FIXTURE BEING REMOVED. CALL ANY EXISTING WIRING DEFICIENCIES THAT ARE UNCOVERED TO ATTENTION OF ENGINEER PRIOR TO PROCEEDING WITH WORK.
2. FURNISH AND INSTALL NEW LIGHTING FIXTURE AT LOCATION WHERE NO EXISTING LIGHTING FIXTURE IS PRESENT. PREPARE AND INSTALL NEW BRANCH CIRCUIT WIRING TO THE EXISTING LIGHTING FIXTURE AS REQUIRED. FIXTURE SHALL BE CONNECTED TO EXISTING LINE VOLTAGE CIRCUIT SERVING OTHER EXTERIOR LIGHTING FIXTURES IN THIS VICINITY. NEW WIRING SHALL BE INSTALLED IN A NEAT AND WORKMANLIKE MANNER, RUN PARALLEL OR PERPENDICULAR TO BUILDING STRUCTURE ELEMENTS. NEW WIRING SHALL BE RUN CONCEALED INSIDE THE BUILDING TO THE MAXIMUM EXTENT PRACTICABLE, WHERE EXPOSED WIRING IS NECESSARY DUE TO EXISTING BUILDING STRUCTURAL CONDITIONS, CONTRACTOR SHALL HAVE PROPER ROUTING OF EXPOSED WIRING APPROVED IN ADVANCE OF INSTALLATION BY ENGINEER.
3. FURNISH AND INSTALL NEW LIGHTING FIXTURE AT LOCATION SHOWN. AT THIS LOCATION, A LIGHTING FIXTURE WAS AT ONE TIME INSTALLED. AT SOME TIME IN PAST, LIGHTING FIXTURE WAS REMOVED AND A BLANK COVERPLATE WAS INSTALLED OVER THE JUNCTION BOX. UTILIZE EXISTING WIRING IN PLACE AT THIS EXISTING JUNCTION BOX TO SERVE EXISTING LIGHTING FIXTURE. CALL ANY EXISTING WIRING DEFICIENCIES THAT ARE UNCOVERED TO ATTENTION OF ENGINEER PRIOR TO PROCEEDING WITH WORK.
4. REMOVE TWO(2) EXISTING LIGHTING FIXTURES AND REPLACE WITH ONE(1) NEW LIGHTING FIXTURE AT LOCATION INDICATED. CONNECT NEW LIGHTING FIXTURE TO EXISTING WIRING SERVING LIGHTING FIXTURE BEING REMOVED. CALL ANY EXISTING WIRING DEFICIENCIES THAT ARE UNCOVERED TO ATTENTION OF ENGINEER PRIOR TO PROCEEDING WITH WORK.
5. REMOVE EXISTING WALL MOUNTED LIGHTING FIXTURE LOCATED ABOVE CANOPY. INSTALL BLANK COVERPLATE OVER J.BOX.
6. AT LOCATIONS NOTED ON DRAWING, LOCATE REPLACEMENT FIXTURES AT HIGHER ELEVATION, CLEAR OF EXISTING CONDUITS THAN EXISTING FIXTURE BEING REMOVED. PROVIDE NEW WIRING TO HIGHER ELEVATION LOCATIONS FROM EXISTING LIGHTING INSTALLATIONS AS REQUIRED.
7. EXISTING CYLINDER FIXTURE TO BE REPLACED WITH NEW CYLINDER. DUE TO MOUNTING RESTRICTIONS, PROVIDE A 4" BOX EXTENSION RING AT LOCATION OF EXISTING FIXTURE ATTACHED TO BUILDING BELOW THIS EXTENSION. BOX MOUNT NEW FIXTURE BACKBOX SO THAT TOP OF NEW FIXTURE FITS UNDER EXISTING STRUCTURE. CONFIRM EXACT REQUIREMENTS IN FIELD.
8. EXISTING LIGHTING FIXTURE TO REMAIN. CLEAN AND RELAMP WITH NEW LED "A" LAMP TO MATCH EXISTING INCANDESCENT LAMP BASE.

GENERAL INSTALLATION NOTES:

1. WHERE NEW UNDERGROUND WIRING IS SHOWN, IT SHALL BE INSTALLED AT A MINIMUM BURIAL DEPTH OF 24" BELOW FINISHED GRADE. CONTRACTOR SHALL VERIFY ROUTINGS OF ALL NEW UNDERGROUND WIRING RUNS PRIOR TO INSTALLATION. WIRING ROUTING LOCATIONS SHOWN ON DRAWINGS ARE DIAGRAMMATIC ONLY.
2. ALL AREAS IMPACTED BY NEW UNDERGROUND WIRING SERVING NEW POLE MOUNTED LIGHTING FIXTURES SHALL BE RESTORED TO THEIR PRE-CONSTRUCTION STATE AS REQUIRED. REFER TO PROJECT MANUAL SECTION 26 07 00, "EXCAVATION AND BACKFILLING" FOR ADDITIONAL INFORMATION.
3. WHERE NEW BUILDING MOUNTED LIGHTING FIXTURES ARE SHOWN REPLACING EXISTING BUILDING MOUNTED LIGHTING FIXTURES, CONTRACTOR SHALL PROVIDE ALL REQUIRED "TOUCH-UP" WORK TO REPAIR AND RESTORE EXISTING SURFACES TO ORIGINAL CONDITION. THIS SHALL INCLUDE, BUT NOT BE LIMITED TO, PATCHING AND PAINTING OF EXISTING WALLS AS REQUIRED.
4. CONTRACTOR SHALL PROVIDE UPDATED TYPEWRITTEN CIRCUIT DIRECTORIES IN EXISTING PANELBOARDS THAT SERVE NEW POLE MOUNTED LIGHTING CIRCUITS.

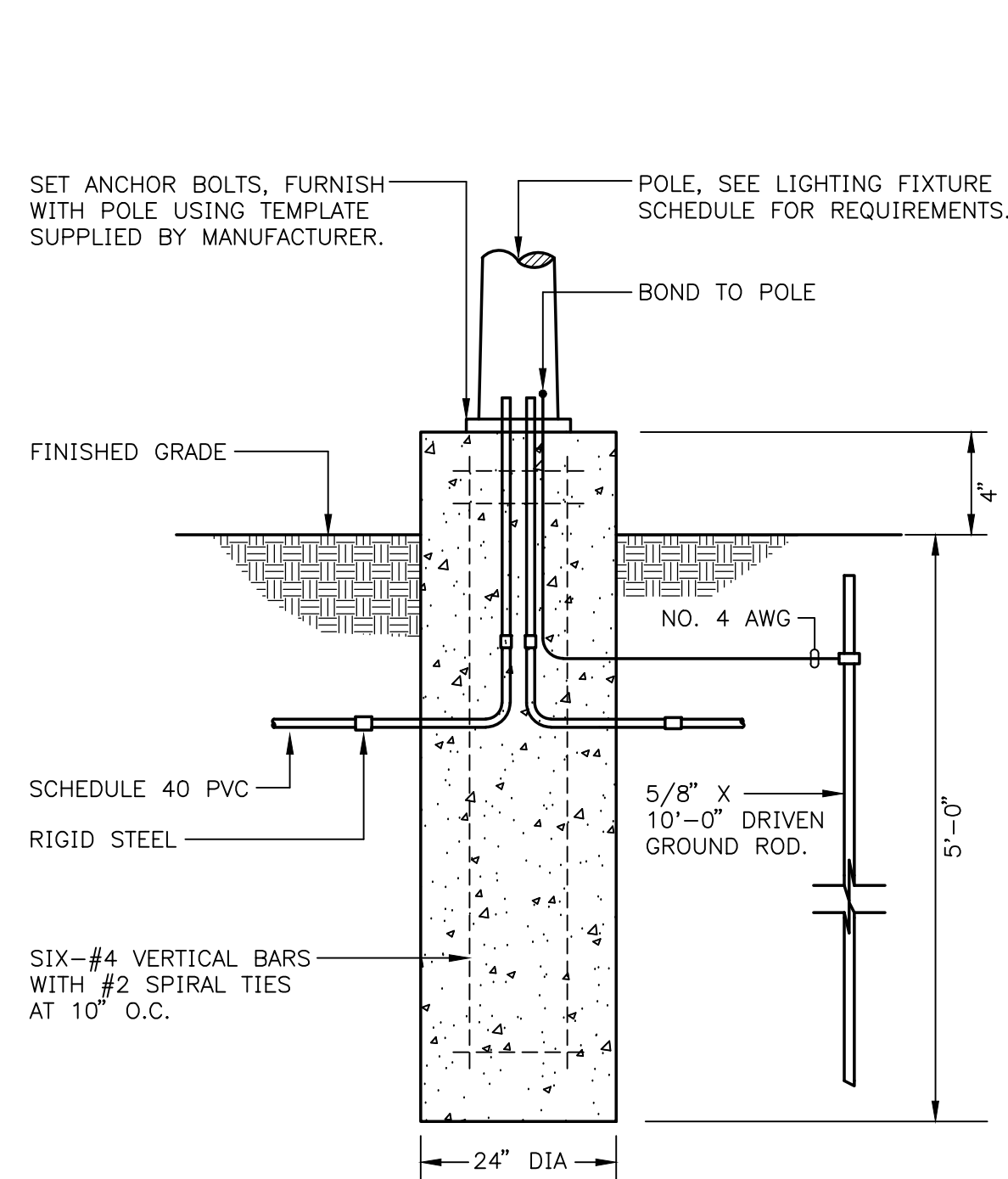

POLE BASE DETAIL (TYPE "SC" AND "SF")
NO SCALE

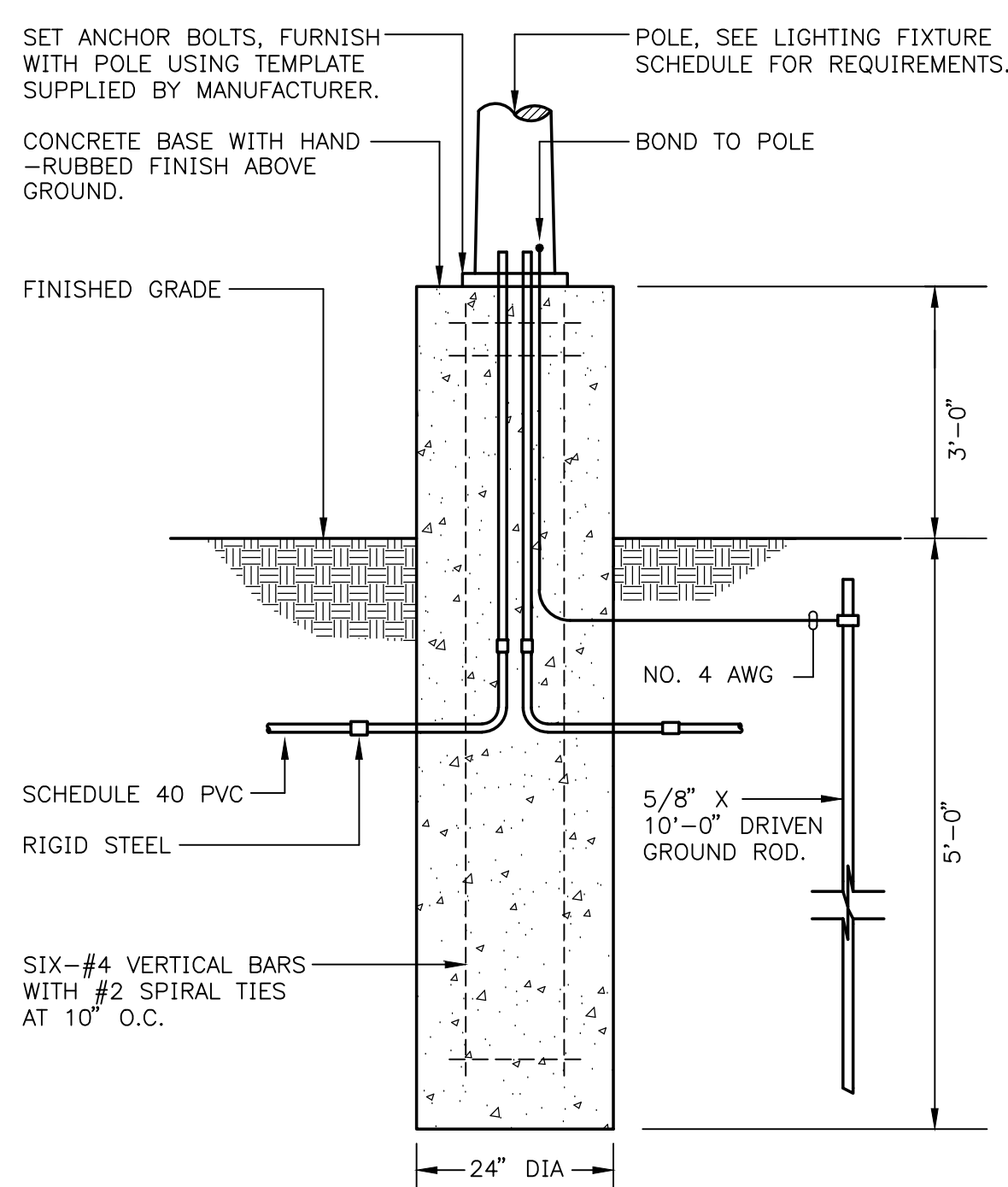

POLE BASE DETAIL
(TYPES "SA","SB","SD","SE")
NO SCALE

BUILDING MOUNTED LIGHTING FIXTURE REPLACEMENT SCHEDULE (SEE LIGHTING PLANS FOR LOCATIONS)										
BUILDING	A1 FIXTURES	A2 FIXTURES	A3 FIXTURES	A4 FIXTURES	A5 FIXTURES	B FIXTURES	C FIXTURES	D FIXTURES	E FIXTURES	F FIXTURES
Oakley	3	4	1							
Jere Whitson	1	1					7			
University Services	2						6	9		
Memorial Gym	6	4	6				6			
Bartoo		1	7				8			
Kittali		1					8			
Foundation Hall	7	5	13			2				18
Academic Wellness Center	2	1			21					3
Roaden University Center		3	1				8			3
Southwest Hall		8								
T. J. Farr	1	2								
Henderson	1			2			2			
Clement	9						2			
Brown	9	1	3				8			
Prescott	11	1					8			
Bruner	12		3				5			
Maint. Comp.-Chilr. Ware./Garage		15								
	6	8								4
Maint. -- Carr Bldg.			8						6	
Maint. -- Admin.			2						8	
Derryberry	3	1	1				2	6		3
Pennebaker	9						6			
Bryan Fine Arts	8						13			
Spare Fixtures (Turn over to owner)	10	6	8			1	11	5	4	4
TOTALS	100	62	60	2	21	3	102	20	18	35

TYPE	SIZE	LAMP BASE & TYPE	MANUFACTURER	CATALOG NUMBER	LOCATIONS
SMALL LANTERN, BLACK FINISH	12- $\frac{3}{4}$ " H, 6-7/8" W, 8- $\frac{3}{8}$ " D	A11 MEDIUM CLEAR LED MAX 13 WATT, 4000 DEGREE K	PROGRESS LIGHTING WESTPORT STYLE	P5862-31	HENDERSON HALL WEST SIDE (2) DERRYBERRY HALL SIDE ENTRANCES (2)
MEDIUM LANTERN, BLACK FINISH	16" H, 9" W, 10- $\frac{3}{8}$ " D	A11 MEDIUM CLEAR LED MAX 13 WATT, 4000 DEGREE K	PROGRESS LIGHTING WESTPORT STYLE	P5863-31	SIDE AND REAR ENTRANCES KITTRELL HALL (6) BARTOO HALL (6)
LARGE LANTERN, BLACK FINISH	19- $\frac{1}{4}$ " H, 11" W, 12-7/8" D	TWO (2) CANDLEBRA BASE LED LAMPS 4000 DEGREE K	PROGRESS LIGHTING WESTPORT STYLE	P5864-31	FRONT ENTRANCES (FACING QUAD) KITTRELL HALL (2) BARTOO HALL (2)
LARGE LANTERN #2, BLACK FINISH	21- $\frac{3}{4}$ " H, 10- $\frac{3}{8}$ " W, 13- $\frac{9}{8}$ " D	THREE (3) CANDLEBRA BASE LED LAMPS 4000 DEGREE K	PROGRESS LIGHTING VERDEAE STYLE	P560016-031	JERE WHITSON (7), MEMORIAL GYM (6), BRYAN FINE ARTS (8), PENNEBAKER (8), BRUNER (3), CLEMENT (2), BROWN (8), PRESCOTT (8)
HANGING LANTERN, BLACK FINISH	OVERALL HT W/CHAIN" 53" 14- $\frac{1}{16}$ " H, 9- $\frac{9}{8}$ " DIAMETER	A11 MEDIUM CLEAR LED MAX 13 WATT, 4000 DEGREE K	PROGRESS LIGHTING WELBOURNE STYLE	P5582-31	BRYAN FINE ARTS WHERE HANGING (TOTAL OF FIVE)
LARGE LANTERN #3, BLACK FINISH	24- $\frac{3}{4}$ " H, 14" W, 18- $\frac{1}{8}$ " D	A11 MEDIUM CLEAR LED MAX 13 WATT, 4000 DEGREE K	PHILIPS LIGHTING	MANOR SERIES 5510-BLK-C-D- 1001-E-N-N-N	ROADEN UNIVERSITY CENTER (8) UNIVERSITY SERVICES BUILDING (6)

Vreeland Engineers Inc.

3107 Sutherland Ave.
P.O. Box 10648
Knoxville, TN 37939
865-637-4451
1-800-362-9789
vreeelandengineers.com

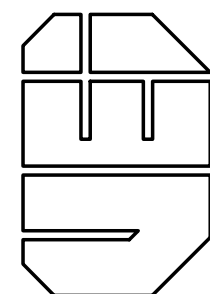

Campus Wide Exterior Lighting Upgrades
Tennessee Technological University
SBC Project No. 364/011-08-2021
Cookeville, Tennessee

DRAWING DESCRIPTION:

LEGEND AND DETAILS

DATE: AUGUST 18, 2025	
REVISIONS:	
1	9-10-25

SHEET NUMBER

E0.1

9

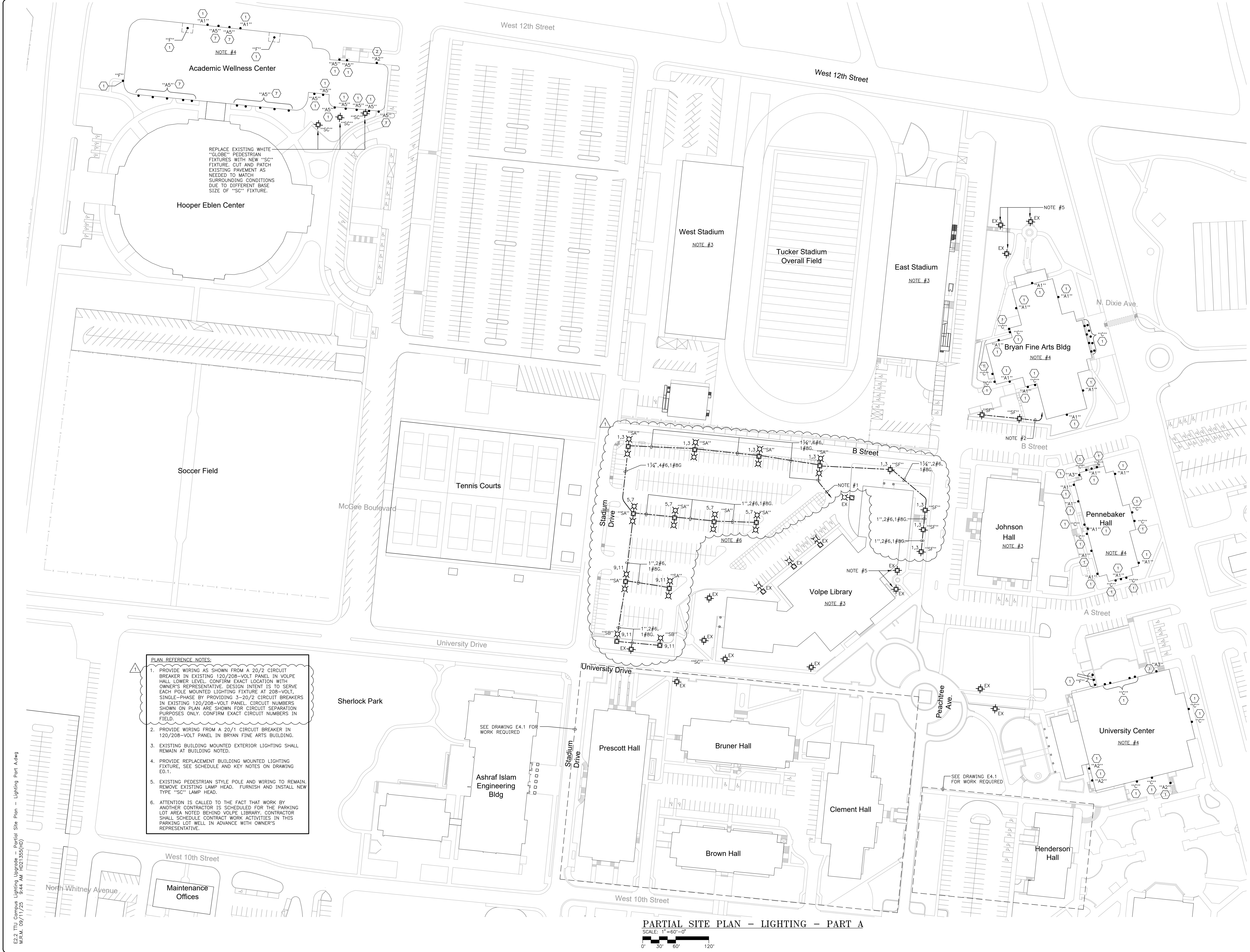

- PLAN REFERENCE NOTES:**
1. PROVIDE WIRING AS SHOWN FROM A 20/2 CIRCUIT BREAKER IN EXISTING 120/208-VOLT PANEL IN VOLPE HALL LOWER LEVEL. CONFIRM EXACT LOCATION WITH OWNER'S REPRESENTATIVE. DESIGN INTENT IS TO SERVE EACH POLE MOUNTED LIGHTING FIXTURE AT 208-VOLT, SINGLE-PHASE BY PROVIDING 3-20/2 CIRCUIT BREAKERS IN EXISTING 120/208-VOLT PANEL. CIRCUIT NUMBERS SHOWN ON PLAN ARE SHOWN FOR CIRCUIT SEPARATION PURPOSES ONLY. CONFIRM EXACT CIRCUIT NUMBERS IN FIELD.
 2. PROVIDE WIRING FROM A 20/1 CIRCUIT BREAKER IN 120/208-VOLT PANEL IN BRYAN FINE ARTS BUILDING.
 3. EXISTING BUILDING MOUNTED EXTERIOR LIGHTING SHALL REMAIN AT BUILDING NOTED.
 4. PROVIDE REPLACEMENT BUILDING MOUNTED LIGHTING FIXTURE, SEE SCHEDULE AND KEY NOTES ON DRAWING E0.1.
 5. EXISTING PEDESTRIAN STYLE POLE AND WIRING TO REMAIN. REMOVE EXISTING LAMP HEAD. FURNISH AND INSTALL NEW TYPE "SC" LAMP HEAD.
 6. ATTENTION IS CALLED TO THE FACT THAT WORK BY ANOTHER CONTRACTOR IS SCHEDULED FOR THE PARKING LOT AREA NOTED BEHIND VOLPE LIBRARY. CONTRACTOR SHALL SCHEDULE CONTRACT WORK ACTIVITIES IN THIS PARKING LOT WELL IN ADVANCE WITH OWNER'S REPRESENTATIVE.

PARTIAL SITE PLAN - LIGHTING - PART A
SCALE: 1"=60'-0"
0' 30' 60' 120'

E2.2 TTU Campus Lighting Upgrade - Partial Site Plan - Lighting Part A.dwg
M.R.M. 09/11/25 9:44 AM H021355(hd)



Vreeland Engineers Inc.
3107 Sutherland Ave.
Knoxville, TN 37939
1-866-637-4451
1-606-582-9789
vreelandengr.com

Campus Wide Exterior Lighting Upgrades
Tennessee Technological University
SBC Project No. 364/011-08-2021
Cookeville, Tennessee

DRAWING DESCRIPTION:
PARTIAL SITE PLAN -
SITE LIGHTING -
PART A

DATE:	AUGUST 18, 2025
REVISIONS:	
1	9-10-25
SHEET NUMBER	

E2.2
OF

E3.1 TTU Campus Lighting Upgrade - Partial Site Plan - Lighting Part B.dwg
M.R.M. 09/10/25 2:33 PM H021355(hd)



PARTIAL SITE PLAN - LIGHTING - PART B

SCALE: 1"=60'-0"
0' 30' 60' 120'

PLAN REFERENCE NOTES:

1. FURNISH AND INSTALL A NEW TYPE "SC" LIGHTING FIXTURE ALONG LOWER SIDEWALK AT LOCATION INDICATED. EXTEND 3/4" 2#10, 1#10G. TO THIS NEW FIXTURE FROM EXISTING CIRCUIT SERVING EXISTING POST TOP SIDEWALK FIXTURE WHERE INDICATED.
2. FURNISH AND INSTALL A NEW TYPE "SC" LIGHTING FIXTURE ALONG SIDEWALK AT LOCATION INDICATED. EXTEND 3/4" 2#10, 1#10G. TO THIS NEW FIXTURE FROM EXISTING CIRCUIT SERVING EXISTING POST TOP SIDEWALK FIXTURE WHERE INDICATED.
3. EXISTING BUILDING MOUNTED EXTERIOR LIGHTING SHALL REMAIN AT BUILDING NOTED.
4. PROVIDE REPLACEMENT BUILDING MOUNTED LIGHTING FIXTURES, SEE SCHEDULE AND KEY NOTES ON DRAWING E0.1.
5. EXISTING PEDESTRIAN STYLE POLE AND WIRING TO REMAIN. REMOVE EXISTING LAMP HEAD. FURNISH AND INSTALL NEW TYPE "SC" LAMP HEAD.



Vreeland Engineers Inc.
3107 Sutherland Ave.
Cookeville, TN 37039
866-637-4451
1-800-636-2789
vreckindg@vreckindg.com

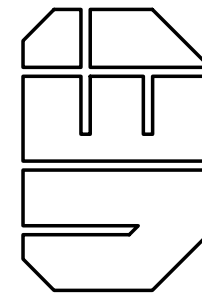

Campus Wide Exterior Lighting Upgrades
Tennessee Technological University
SBC Project No. 364/011-08-2021
Cookeville, Tennessee

DRAWING DESCRIPTION:
PARTIAL SITE PLAN -
SITE LIGHTING -
PART B

DATE:	AUGUST 18, 2025
REVISIONS:	
1	9-10-25
SHEET NUMBER	

E3.1

OF

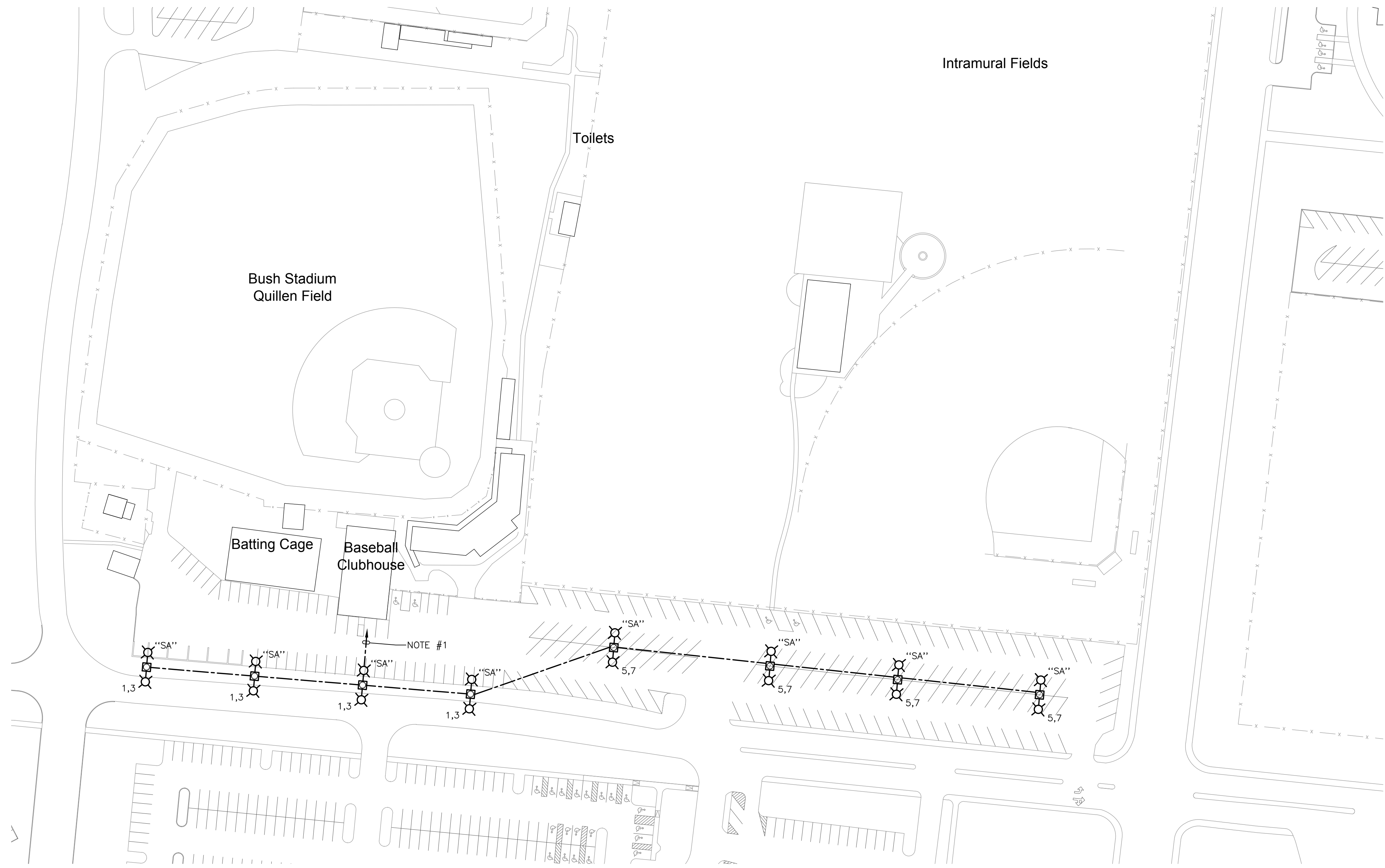

PARTIAL SITE PLAN - LIGHTING - PART E - ADD ALTERNATE NO. 1

SCALE: 1"=60'-0"
0' 30' 60' 120'

PLAN REFERENCE NOTE:

1. EXTEND 1¼", #8, 1#10G. FROM EXISTING PANELBOARD IN EXISTING BASEBALL CLUBHOUSE BUILDING TO SERVE NEW POLE MOUNTED LIGHTING FIXTURES INDICATED. FURNISH AND INSTALL 2-20/2 CIRCUIT BREAKERS TO SERVE THESE CIRCUITS. DESIGN INTENT IS TO SERVE THE NEW POLE MOUNTED LIGHTING FIXTURES AT 208-VOLT, SINGLE-PHASE CIRCUIT NUMBERS SHOWN BY LIGHTING FIXTURES ARE SHOWN FOR CIRCUIT SEPARATION PURPOSES ONLY. CONFIRM CIRCUIT NUMBERS IN FIELD. PROVIDE UPDATED TYPEWRITTEN CIRCUIT DIRECTORY REFLECTING CHANGES MADE ON THIS PROJECT. UTILIZE #8 AWG WIRING FOR PHASE CONDUCTORS AND #10 AWG WIRING FOR EQUIPMENT GROUNDING FOR THE ENTIRE LENGTH OF WIRING RUN.



Vreeland Engineers Inc.
3107 Sutherland Ave.
Knoxville, TN 37939
866-637-4451
423-582-3789
vreelandengr.com

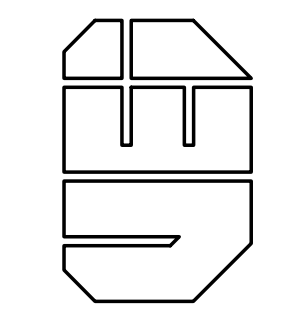

Campus Wide Exterior Lighting Upgrades
Tennessee Technological University
SBC Project No. 364/011-08-2021
Cookeville, Tennessee

DRAWING DESCRIPTION:
PARTIAL SITE PLAN -
SITE LIGHTING -
PART E - ADD
ALTERNATE NO. 1

DATE:	AUGUST 18, 2025
REVISIONS:	
△	9-10-25

SHEET NUMBER

E6.1
OF

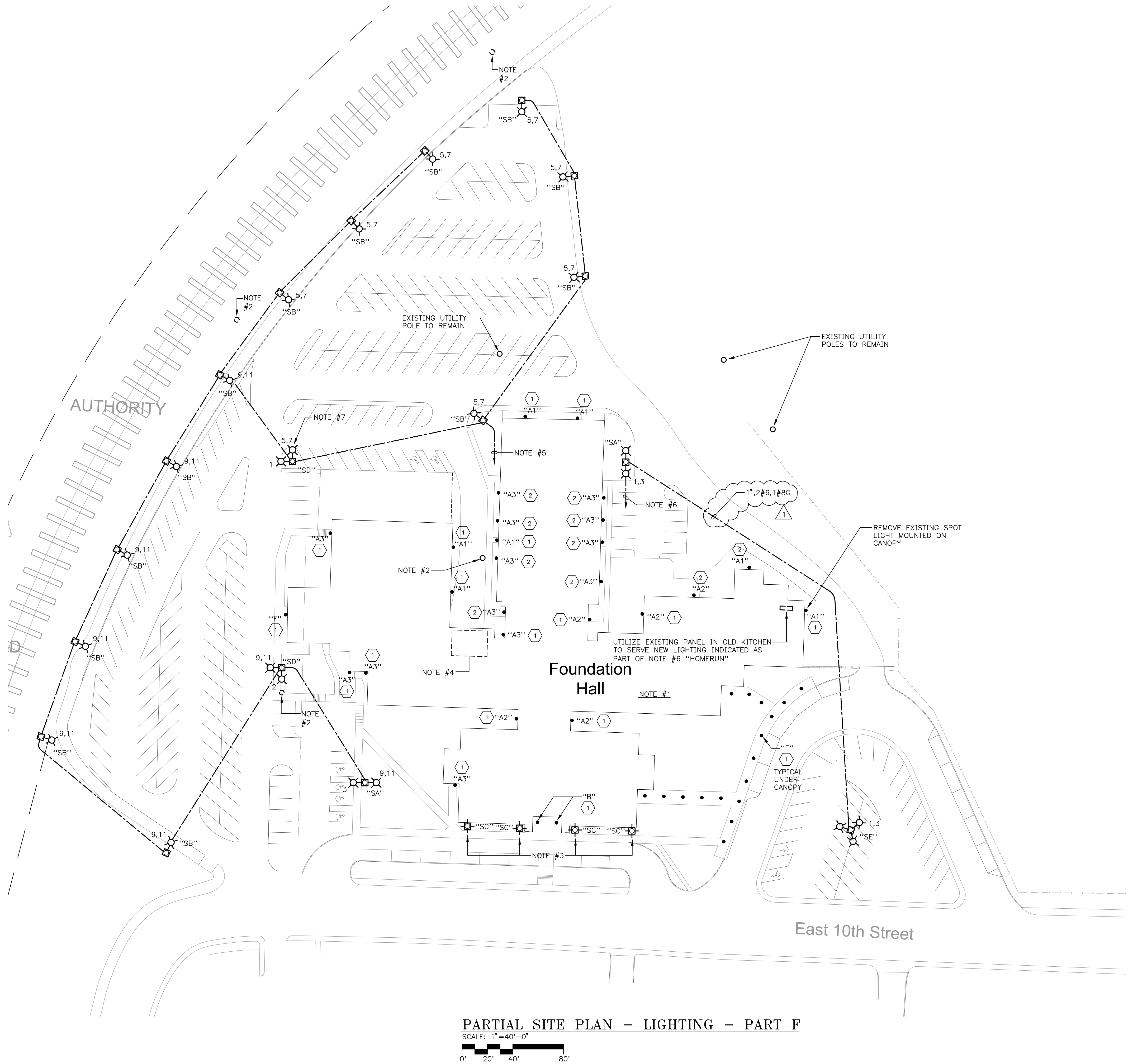

PARTIAL SITE PLAN - LIGHTING - PART F

SCALE: 1"=40'-0"

PLAN REFERENCE NOTES:

1. PROVIDE REPLACEMENT BUILDING MOUNTED LIGHTING FIXTURES, SEE SCHEDULE AND KEY NOTES ON DRAWING E0.1.
2. EXISTING WOODEN POLE WITH UTILITY COMPANY LUMINAIRE MOUNTED ON POLE. ARRANGE WITH LOCAL UTILITY COMPANY TO REMOVE POLE, LUMINAIRE, AND ALL ASSOCIATED OVERHEAD WIRING.
3. AT LOCATION INDICATED, REMOVE EXISTING POST TOP PEDESTRIAN STYLE LIGHTING FIXTURE AND REPLACE WITH NEW "SC" FIXTURE, INCLUDING NEW CONCRETE BASE. RECONNECT NEW TYPE "SC" LIGHTING FIXTURE TO EXISTING WIRING SERVING POST TOP LIGHTING FIXTURES BEING REMOVED.
4. EXISTING 120/208V. PANELBOARD TO BE USED TO SERVE NEW EXTERIOR LIGHTING CIRCUIT IS LOCATED IN THIS AREA. COORDINATE TIE-IN REQUIREMENTS WITH TTU MAINTENANCE STAFF.
5. EXTEND 1/4" 4#6,1#8G FROM EXISTING ELECTRICAL PANEL (120/208/3) IN MAIN ELECTRICAL ROOM AREA TO SERVE NEW POLE LIGHTING INDICATED. FURNISH AND INSTALL TWO NEW 20/2 CIRCUIT BREAKERS TO SERVE THIS LINE. PROVIDED UPDATED TYPE WRITTEN CIRCUIT DIRECTORY REFLECTING THIS CHANGE. DESIGN INTENT IS TO SERVE THE NEW POLE MOUNTED LIGHTING FIXTURES AT 208-VOLTS, SINGLE-PHASE. UTILIZE #6 AWG (PHASE) AND #8 AWG (EQ. GROUND) THE ENTIRE LENGTH OF RUN. CIRCUIT NUMBERING IS SHOWN FOR CIRCUIT SEPARATION PURPOSES ONLY. CONFIRM CIRCUIT NUMBERS IN FIELD.
6. EXTEND 1" 2#6,1#8G FROM EXISTING ELECTRICAL PANEL (120/208/3) IN EXISTING KITCHEN AREA TO SERVE NEW POLE LIGHTING INDICATED. FURNISH AND INSTALL A NEW 20/2 CIRCUIT BREAKER TO SERVE THIS LINE. PROVIDED UPDATED TYPE WRITTEN CIRCUIT DIRECTORY REFLECTING THIS CHANGE. DESIGN INTENT IS TO SERVE THE NEW POLE MOUNTED LIGHTING FIXTURES AT 208-VOLTS, SINGLE-PHASE. CIRCUIT NUMBERING SHOWN IS FOR CIRCUIT SEPARATION ONLY. CONFIRM CIRCUIT NUMBERS IN FIELD.
7. ARRANGE WITH LOCAL UTILITY COMPANY TO REMOVE EXISTING WOODEN POLE, LUMINAIRE MOUNTED ON POLE, AND ALL ASSOCIATED WIRING. REPLACE WITH NEW POLE MOUNTED FIXTURE AND WIRING SHOWN.



Vreeland Engineers Inc.
3107 Sutherland Ave.
Knoxville, TN 37939
866-637-4451
1-800-636-3789
vree@vreeengineers.com

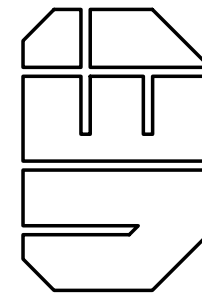

Campus Wide Exterior Lighting Upgrades
Tennessee Technological University
SBC Project No. 364/011-08-2021
Cookeville, Tennessee

DRAWING DESCRIPTION:

PARTIAL SITE PLAN -
SITE LIGHTING -
PART F

DATE:
AUGUST 18, 2025

REVISIONS:

9-10-25

SHEET NUMBER

E7.1

OF